

SECTION

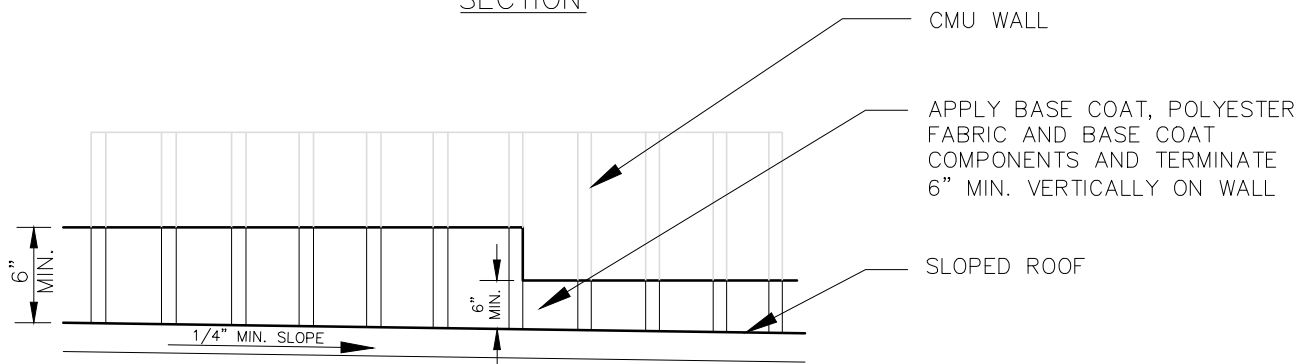

ELEVATION

- SURFACE COAT POLYBRITE 70 OR PG 700 ELASTOMERIC ROOF COATINGS. APPLY A MINIMUM OF 2 COATS.
- BASE COAT POLYBRITE 70, POLYBRITE 76, OR PG 700 ELASTOMERIC ROOF COATINGS. APPLY A MINIMUM OF 2 COATS.
- FLASHING COMPOUND POLYBRITE 72 FLASHING COMPOUND WHERE REQUIRED. APPLY AT 1/8" THICK. *REQUIRED FOR POLYGLASS COATING SYSTEM WARRANTY. OPTIONAL; OTHER POLYGLASS EXTENDED MANUFACTURER'S WARRANTIES.
- POLYESTER POLYBRITE REINFORCING POLYESTER. *REQUIRED FOR POLYGLASS COATING SYSTEM WARRANTY. OPTIONAL; OTHER POLYGLASS EXTENDED MANUFACTURER'S WARRANTIES.
- SURFACE PREPARATION IF OXIDATION IS PRESENT, GRINDING AFFECTED AREAS WITH WIRE BRUSH IS NECESSARY. THEN PRIME ENTIRE ROOF WITH POLYBRITE 74 RUST INHIBITOR PRIMER APPLIED AT THE RATE OF 18-24 WET MILS (150-180 SQUARE FEET PER GALLON).

ROOF TO
WALL DETAIL

NUMBER:

PG-RWD-013

DATE:

MARCH 2014



www.polyglass.com